

Courtesy Of Kenton T King Of MaxWell Progressive

# \$275,000 - 7 26328 Twp Road 511, Rural Parkland County

MLS® #E4430569

**\$275,000**

0 Bedroom, 0.00 Bathroom,  
Rural on 2.01 Acres

West Glen Estates, Rural Parkland County, AB

Get started on your dream home build at West Glen Estates where youâ€™ll get tremendous value with this 2 acre lot! This amazing 74 acre subdivision is located in Parkland County just west of Hwy 60 on the corner of Graminia & Sanctuary Road. Gentle rolling terrain, an abundance of trees, paved road, and bordered on two sides by environmentally protected wetlands & Ducks Unlimited nesting projects. Graminia School ( K-9) is located 5 Km West on Graminia Road, Nisku and the Edmonton International Airport are only 15 minutes away, and the Town of Devon is only 5 minutes away with volunteer fire department, full service RCMP facility, hospital & ambulance service, with many more amenities and services available. PLUS major tourist attractions such as RAD Torque Raceway, U of A Botanic Gardens, Rabbit Hill Snow Resort, Canada Petroleum Discover Centre, Clifford E. Lee Nature Sanctuary, Devon Voyageur Park and Prospectors Point are only minutes away. A beautiful place to call home!

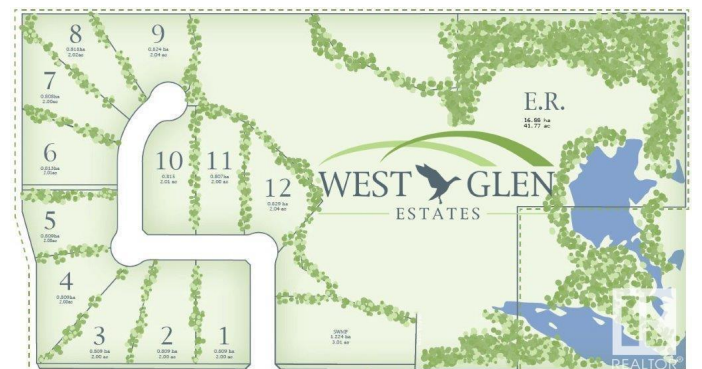

## Essential Information

MLS® #	E4430569
Price	\$275,000
Bathrooms	0.00

Acres	2.01
Type	Rural
Sub-Type	Vacant Lot/Land
Status	Active

### **Community Information**

Address	7 26328 Twp Road 511
Area	Rural Parkland County
Subdivision	West Glen Estates
City	Rural Parkland County
County	ALBERTA
Province	AB
Postal Code	T7Y 1E1

### **Exterior**

Exterior Features Airport Nearby, Environmental Reserve, Golf Nearby, Rolling Land

### **Additional Information**

Date Listed	April 11th, 2025
Days on Market	14
Zoning	Zone 90

DATA IS DEEMED RELIABLE BUT IS NOT GUARANTEED ACCURATE BY THE REALTORS® ASSOCIATION OF EDMONTON. COPYRIGHT 2025 BY THE REALTORS® ASSOCIATION OF EDMONTON. ALL RIGHTS RESERVED. Trademarks are owned or controlled by the Canadian Real Estate Association (CREA) and identify real estate professionals who are members of CREA (REALTOR®, REALTORS®) and/or the quality of services they provide (MLS®, Multiple Listing Service®)

Listing information last updated on April 25th, 2025 at 8:02am MDT